



P.O. Box 65
No. 4 Executive Circle
Arkadelphia, AR 71923
(870) 246-5757
FAX 1-870-367-8424
E-mail: arkadelphia@kingwoodforestry.com



Other Kingwood
Locations:
P.O. Box 1290
145 Greenfield Drive
Monticello, AR 71657
(870) 367-8567
FAX 1-870-367-8424

P.O. Box 5887
4414 Galleria Oaks
Texarkana, TX 75505
(903) 831-5200
FAX 1-870-367-8424

NOTICE OF TIMBER SALE

Gifford North Tract – Hot Spring County, Arkansas

Bid Date: Friday, October 3, 2025 @ 10:00 a. m.

Kingwood Forestry Services has been authorized to solicit bids for the sale of all merchantable timber on 73.3 acres, plus selectively marked pine sawtimber within 5-acre Streamside Management Zone (SMZ), more or less, in Hot Spring County, Arkansas.

Location: Timber to be sold is on land described as Part of Section 21, Township 4 South, Range 16 West, clearcut timber sale area containing 73.3 acres, more or less, plus selectively marked pine trees within 5-acre SMZ, more or less, Hot Spring County, Arkansas (Gifford North Tract – see attached maps).

Timber to be Sold: All merchantable timber within the designated clearcut sale area is to be sold. Timber sale boundaries have been marked with pink Timber Harvest Boundary (THB) flagging and blue paint. Kingwood Forestry conducted an inventory of merchantable timber (73 points / plots) in September, 2025. Streamside Management Zones (SMZ) have been delineated with orange SMZ flagging and blue paint; selected pine sawtimber to be sold within SMZ has been marked with two (2) spots of blue paint; once at ground level and once at eye level or above. Based on cruise within clearcut area (± 73.3 acres) and 100% tally within SMZ (± 5 acres), estimated tree counts and timber volumes are as follows:

±73.3 CLEARCUT ACRES			Due to variations in cruising methods, utilization standards, and scaling practices, tree counts and volume estimates cannot be guaranteed. Marked tree count, however, is guaranteed to be accurate. Volume reports are attached.
Pine Sawtimber:	2,561 Trees	4,268 Tons	
Pine Chip N’ Saw:	419 Trees	239 Tons	
Pine Pulpwood:	2,780 Trees	874 Tons	
Pine Topwood:	----	568 Tons	
Gum & Misc. Sawtimber:	20 Trees	13 Tons	
Hardwood Pulpwood:	2,521 Trees	599 Tons	
±5 ACRES OF SELECTIVELY MARKED PINE SAWTIMBER			www.kingwoodforestry.com
Pine Sawtimber:	16 Trees	34 Tons	

Based on our estimates pine sawtimber to be sold within clearcut sale area averages 17.5" DBH.

Method of Sale: Timber will be sold on the basis of lump sum sealed bids. A bid form is attached. Bids will be opened at **10:00 a.m., Friday, October 3, 2025**, at the Kingwood Forestry office at #4 Executive Circle, Arkadelphia. Buyers submitting bids are welcome to attend the bid opening. Mailed bids should be addressed to Kingwood Forestry Services, Inc., P.O. Box 65, Arkadelphia, AR 71923, with **"Gifford North Tract Timber Sale"** clearly marked in the lower left corner of the envelope. Telephone bids from buyers known to Kingwood will be accepted; however, it is preferred that bids be delivered by fax to 870-367-8424 or by e-mail to arkadelphia@kingwoodforestry.com. Faxed / e-mailed bids will be immediately acknowledged. Please await confirmation that your faxed / email bid has been received. Anyone submitting a bid for the purchase of the timber will be provided with a summary of the bid results.

CONDITIONS OF SALE

1. The landowner reserves the right to accept or reject any bid.
2. A performance deposit of \$1,500.00 is to be paid to Kingwood Forestry Services Escrow and will be held until all work is completed satisfactorily.
3. Conveyance will be by conventional Forest Products Sale Contract providing twenty-four (24) months from date of contract execution to harvest and remove the designated timber.
4. Buyer must notify Kingwood Forestry Services, Inc. two (2) days prior to start of harvesting operation.
5. Logging damage must be held to a minimum. Compliance with Best Management Practices for Arkansas will be required.

For more information, contact Jimmy Don Thomas or Phil Wright of Kingwood Forestry Services, Inc. at 870-246-5757 or by e-mail to Arkadelphia@kingwoodforestry.com

NOTICE OF TIMBER SALE
Poor Property "Gifford North Tract"
Pt. Sec. 21, T4S, R16W, Hot Spring County, Arkansas
Containing 73.3 acres (clearcut) and 5.0 acres (twice blue spotted pine sawtimber)

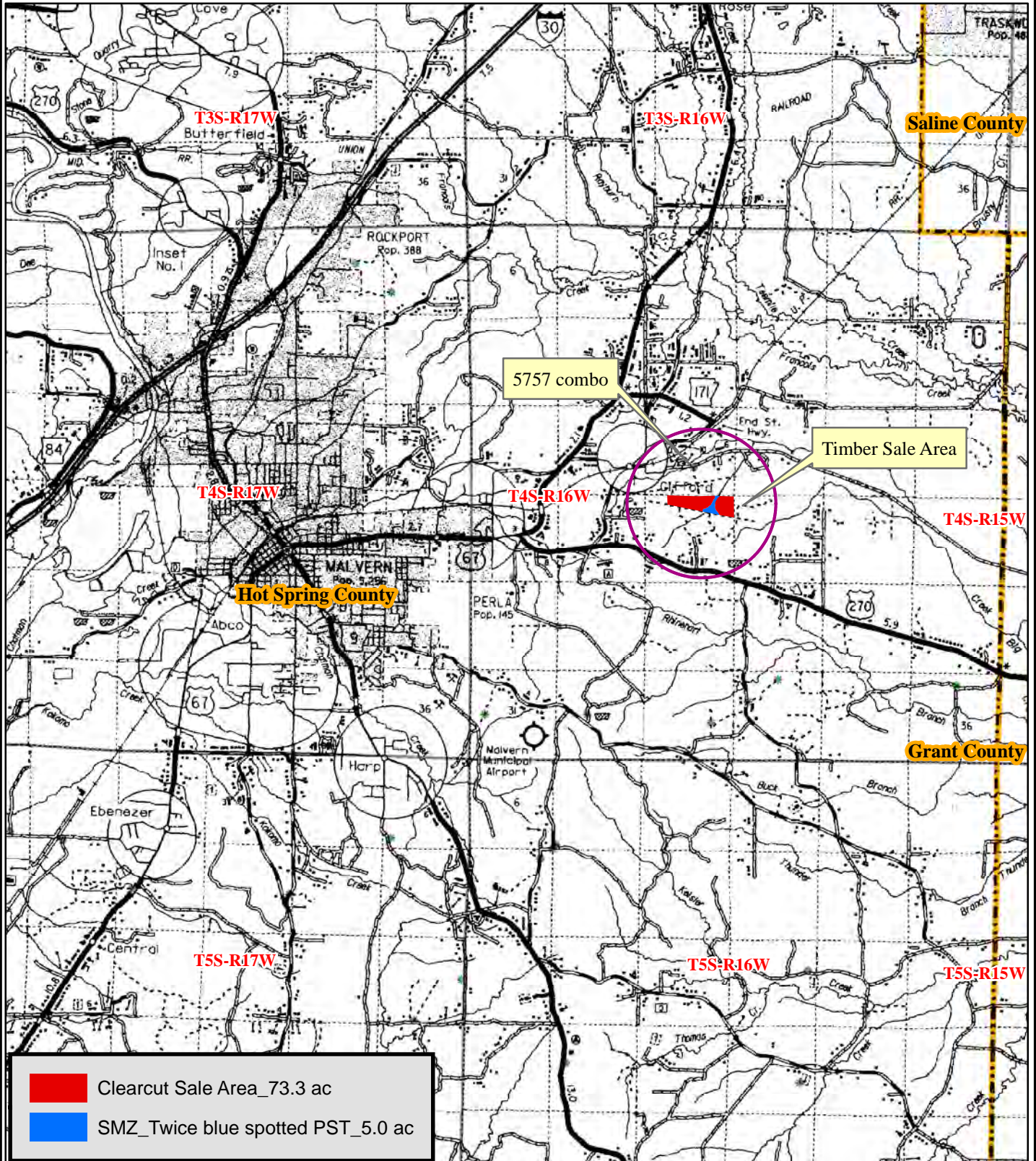

NOTICE OF TIMBER SALE
Poor Property "Gifford North Tract"
Pt. Sec. 21, T4S, R16W, Hot Spring County, Arkansas
Containing 73.3 acres (clearcut) and 5.0 acres (twice blue spotted pine sawtimber)

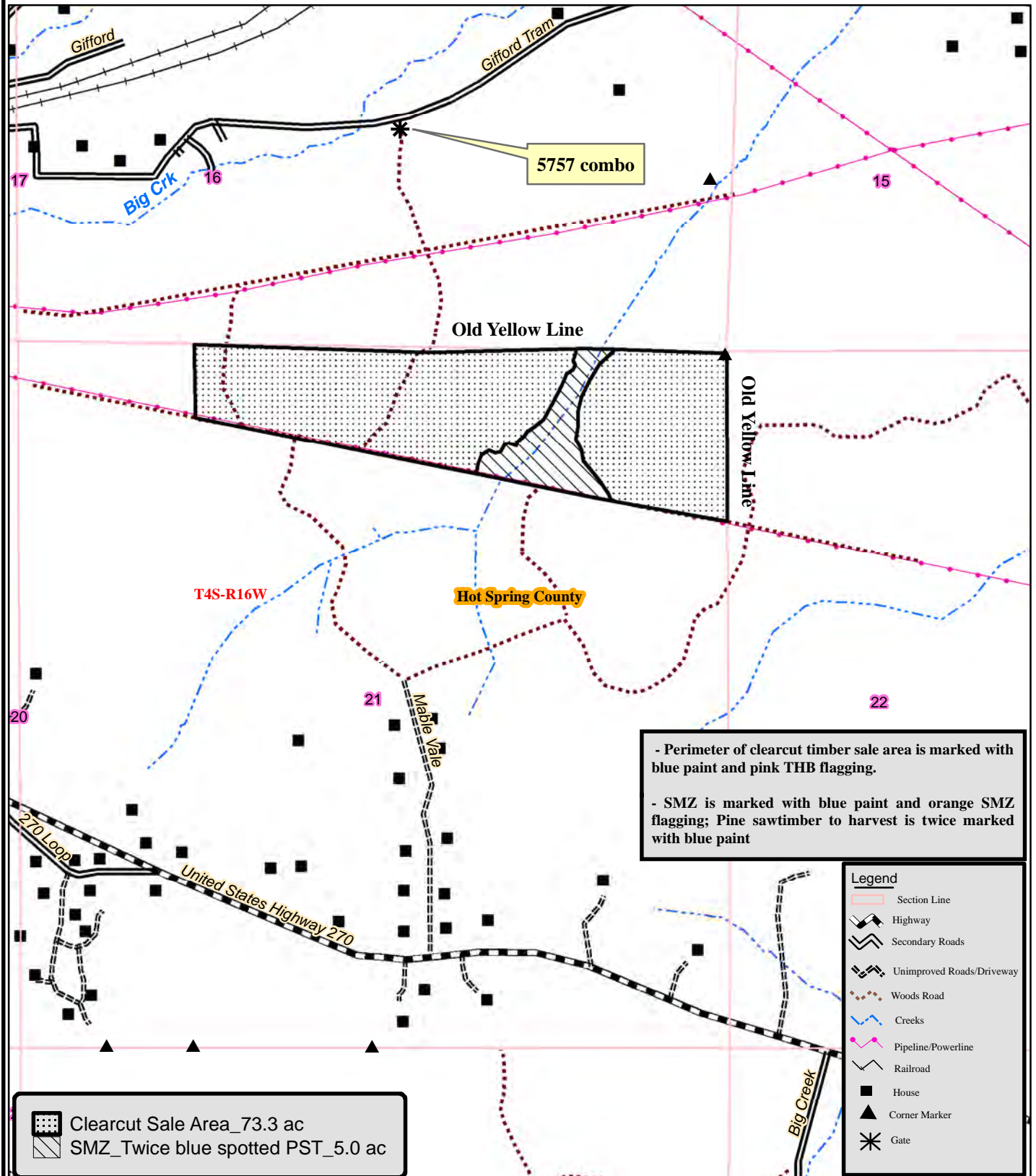

0 0.125 0.25
Miles



Created: Date: 9/3/2025
By: JDT

Stand Summary by Group, Product and DBH

Sampling Method:	Plot
BAF / Plot Size:	0.1
# Plots/points:	73
Stand Acres:	73.3
Cruiser:	JDT
Template:	GENERIC

Tract Name:	Gifford North
Stand ID:	Clearcut Sale Area
Location:	Hot Spring County AR
Date Cruised:	9/3/2025
Sawlog Vol Units:	Doyle

Site Index Species:	Planted Loblolly
Base Age:	25
Site Index:	0.0
# SI Samples:	0
Avg Age:	0
Avg Ht:	0.0



Pine

	Stand Total					Per Acre					Avg. Tree		Avg. Heights		
	DBH	Trees	PW Tons	Saw Tons	MBF	BA	Trees	PW Tons	Saw Tons	BF	Tons/Tree	BF/Tree	Hs	Hp	Hm
Pulpwood	5	220.9	25.3			0.41	3.0	0.34			0.114			35.0	49.0
	6	613.7	102.2			1.64	8.4	1.39			0.167			39.5	51.8
	7	676.3	159.1			2.47	9.2	2.17			0.235			43.9	55.9
	8	388.3	121.0			1.85	5.3	1.65			0.312			47.2	58.2
	9	306.8	130.0			1.85	4.2	1.77			0.424			53.7	65.2
	10	414.2	210.3			3.08	5.7	2.87			0.508			53.0	63.3
	11	68.5	42.7			0.62	0.9	0.58			0.624			55.4	65.2
	12	19.2	12.9			0.21	0.3	0.18			0.673			49.9	57.5
	13	49.0	41.6			0.62	0.7	0.57			0.849			55.6	63.8
	14	14.1	14.9			0.21	0.2	0.20			1.056			62.0	70.5
	17	9.6	14.1			0.21	0.1	0.19			1.475			59.5	66.5
Pulpwood Total		2,780.6	874.0			13.15	37.9	11.92			0.314			45.8	57.4
Chip-N-Saw	10	203.3	8.8	104.6	9.5	1.51	2.8	0.12	1.43	129.90	0.514	46.828	46.4	60.2	72.3
	11	216.3	12.8	134.7	11.7	1.95	3.0	0.17	1.84	159.17	0.623	53.929	47.8	62.6	73.9
Chip-N-Saw Total		419.7	21.6	239.2	21.2	3.46	5.7	0.30	3.26	289.07	0.570	50.489	47.1	61.4	73.1
Sawtimber	12	247.4	36.2	161.1	14.2	2.65	3.4	0.49	2.20	194.12	0.651	57.513	39.1	62.0	73.7
	13	187.0	32.8	140.6	13.7	2.35	2.6	0.45	1.92	187.54	0.752	73.497	38.9	62.6	73.1
	14	235.2	29.8	239.3	24.7	3.43	3.2	0.41	3.26	337.64	1.017	105.248	48.3	68.3	79.1
	15	225.4	35.4	267.5	30.0	3.77	3.1	0.48	3.65	409.96	1.187	133.336	49.8	71.2	81.6
	16	352.9	61.0	481.1	57.5	6.72	4.8	0.83	6.56	784.97	1.363	163.030	51.3	72.3	82.3
	17	170.7	34.0	270.3	34.5	3.67	2.3	0.46	3.69	470.12	1.584	201.874	54.0	75.8	85.2
	18	329.8	67.0	605.9	81.2	7.95	4.5	0.91	8.27	1107.44	1.837	246.106	56.9	78.4	87.6
	19	226.2	54.9	456.7	63.7	6.08	3.1	0.75	6.23	868.64	2.019	281.530	56.8	78.6	87.3
	20	100.4	24.6	225.8	33.1	2.99	1.4	0.34	3.08	451.78	2.248	329.796	56.6	78.5	86.8
	21	130.5	33.4	330.3	49.7	4.28	1.8	0.46	4.51	678.06	2.531	380.754	59.2	80.3	88.7
	22	130.5	45.3	354.7	56.1	4.70	1.8	0.62	4.84	765.84	2.717	430.051	56.1	81.1	89.6
	23	100.4	23.0	312.2	49.3	3.95	1.4	0.31	4.26	672.96	3.109	491.264	63.6	80.7	88.7
	24	65.0	48.1	184.3	32.1	2.79	0.9	0.66	2.51	438.19	2.834	493.832	44.9	80.8	88.6
	25	40.2	10.4	152.9	25.8	1.87	0.5	0.14	2.09	352.08	3.808	642.554	65.0	85.0	92.8
	26	10.0	6.8	36.5	6.7	0.51	0.1	0.09	0.50	90.86	3.637	663.246	50.5	84.5	90.5
	28	10.0	4.0	49.6	9.1	0.59	0.1	0.05	0.68	123.60	4.943	902.311	65.0	92.5	99.5
Sawtimber Total		2,561.8	546.6	4,268.8	581.5	58.30	34.9	7.46	58.24	7933.80	1.666	227.010	51.6	73.7	83.3
Group Total		5,762.0	1,442.1	4,508.0	602.7	74.91	78.6	19.67	61.50	8222.87	0.934	104.605	51.0	59.3	70.0

Misc. Hardwood

	Stand Total					Per Acre					Avg. Tree		Avg. Heights		
	DBH	Trees	PW Tons	Saw Tons	MBF	BA	Trees	PW Tons	Saw Tons	BF	Tons/Tree	BF/Tree	Hs	Hp	Hm
Pulpwood	5	220.9	19.1			0.41	3.0	0.26			0.086			24.5	27.0
	6	777.1	98.4			2.08	10.6	1.34			0.127			25.3	28.5
	7	507.2	87.7			1.85	6.9	1.20			0.173			25.4	28.9
	8	365.3	86.4			1.74	5.0	1.18			0.237			27.6	30.2
	9	190.5	52.8			1.15	2.6	0.72			0.277			24.5	28.6
	10	138.1	53.5			1.03	1.9	0.73			0.388			29.3	32.1
	11	91.3	38.0			0.82	1.2	0.52			0.416			24.5	30.5
	12	57.5	32.8			0.62	0.8	0.45			0.571			29.8	34.5
	13	98.0	67.6			1.23	1.3	0.92			0.689			31.2	34.8
	14	28.2	23.1			0.41	0.4	0.31			0.818			32.5	35.5
	15	36.8	28.4			0.62	0.5	0.39			0.771			24.5	30.5
	16	10.8	11.7			0.21	0.1	0.16			1.082			32.5	36.5
Pulpwood Total		2,521.8	599.4			12.16	34.4	8.18			0.238			26.1	29.5
Large ST	16	20.1	0.0	13.2	1.5	0.38	0.3	0.00	0.18	20.15	0.656	73.550	16.5	16.5	20.5
Large ST Total		20.1	0.0	13.2	1.5	0.38	0.3	0.00	0.18	20.15	0.656	73.550	16.5	16.5	20.5
Group Total		2,541.9	599.4	13.2	1.5	12.54	34.7	8.18	0.18	20.15	0.241	0.581	16.5	26.1	29.4

TIMBER SALE BID FORM

Gifford North Tract – Hot Spring County, Arkansas

Bid Date: Friday, October 3, 2025 @ 10:00 a.m.

Send Completed Offer Forms to us:

Mail: P.O. Box 65, Arkadelphia, AR 71923

Fax: 870-367-8424

Hand Deliver: #4 Executive Circle, Arkadelphia, AR 71923

E-mail: arkadelphia@kingwoodforestry.com

I submit the following as an offer for the purchase of all merchantable timber within designated clearcut sale area, plus selectively marked pine sawtimber within SMZ, on the Gifford North Tract, further described as Part of Section 21, Township 4 South, Range 16 West, clearcut timber sale area containing 73.3 acres, more or less, plus selectively marked pine trees within 5-acre SMZ, more or less, Hot Spring County, Arkansas (Gifford North Tract – see attached maps).

My offer will remain valid through 10:00 a.m. Tuesday, October 7, 2025. Successful bidder will be notified at or before that time by telephone, fax, or e-mail. If my offer is accepted, I am ready, willing, and able to execute a Forest Products Sale Contract within ten (10) business days with payment in full due at time of contract execution.

Send offer form to: Kingwood Forestry Services, Inc. (**Before 10:00 a.m., Friday, October 3, 2025**)

P.O. Box 65, Arkadelphia, AR 71923 or fax to 870-367-8424 or

E-mail completed Bid Form to Arkadelphia@kingwoodforestry.com

Gifford North Tract Timber Bid: \$ _____

(All merchantable timber in designated sale area plus selectively marked pine sawtimber in SMZ)

Date: _____ Fax #: _____

Company: _____ Phone #: _____
Printed

Name: _____ Name: _____
Printed Signed

Address: _____
Street City, State, Zip

Email: _____

